

# Recessed Track

Insolit

Carril electrificado empotrable de 4 conductores con dos rieles laterales que permiten la sujeción de paneles de techo.

*Recessed electrified 4-conductor track with two side flanges allowing the support of ceiling panels.*

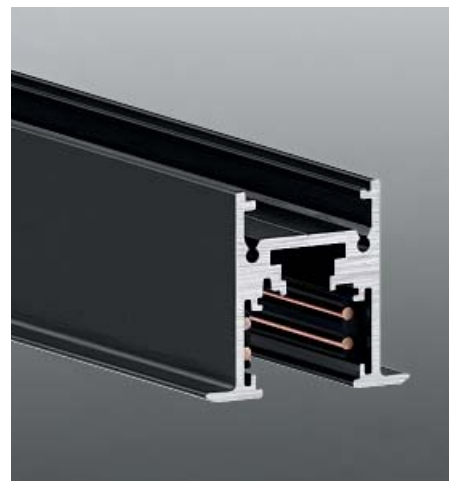

**Recessed Track 0002**

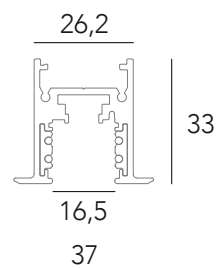

## Acabados / Finishes

Blanco / White  
Negro / Black



# INSOLIT

Pl. Cardona, 7 Bjs. 2ª, 08006 Barcelona  
+34 932 50 76 40 • [insolit@insolitbcn.com](mailto:insolit@insolitbcn.com) • [insolitbcn.com](http://insolitbcn.com)

0002

Recessed Track



Carril electrificado empotrable de 4 conductores con dos rieles laterales que permiten la sujeción de paneles de techo.

Recessed electrified 4-conductor track with two side flanges allowing the support of ceiling panels.

Código / Code	0002
Acabados / Finishes	01 Blanco / White 03 Negro / Black
Longitud / Length	01 1 Metro / 1 Meter 02 2 Metros / 2 Meters 03 3 Metros / 3 Meters
Diseñador / Designer	Insolit
Año / Year	2025
Peso / Weight	885 gr ( 1 M ) - 1170 gr ( 2 M ) - 2655 gr ( 3 M )
Alimentación LED / LED tension	60V 15A
Instalación / Installation	Ver páginas finales. See last pages.

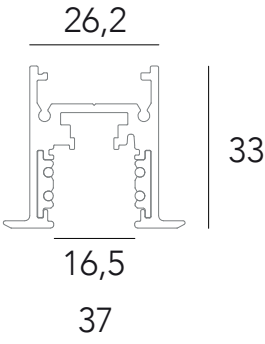

Fabricado según normativa EN60598-1 y regulaciones pertinentes. / Manufactured according EN60598-1 normative and relevant regulations.



# Recessed Track

Insolit

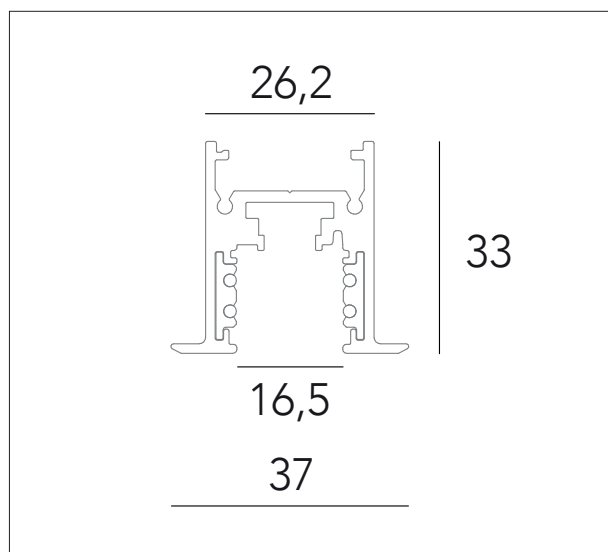

## INSOLIT

Pl. Cardona, 7 Bjs 2ª  
08006 Barcelona  
+34 932 50 76 40  
insolit@insolitbcn.com  
insolitbcn.com

# Recessed Track

Insolit

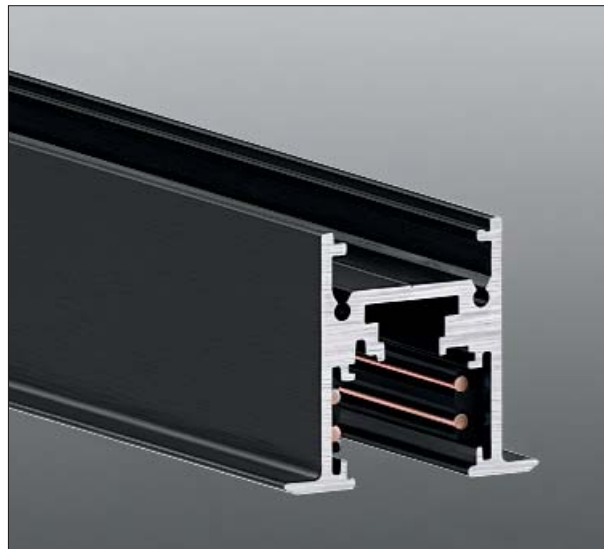

## 000201XX

**Instrucciones de montaje**

*Installation instructions*

## INSOLIT

**Instalación y conexión** / *Installation and Connection*

Ver páginas siguientes / *See next pages*

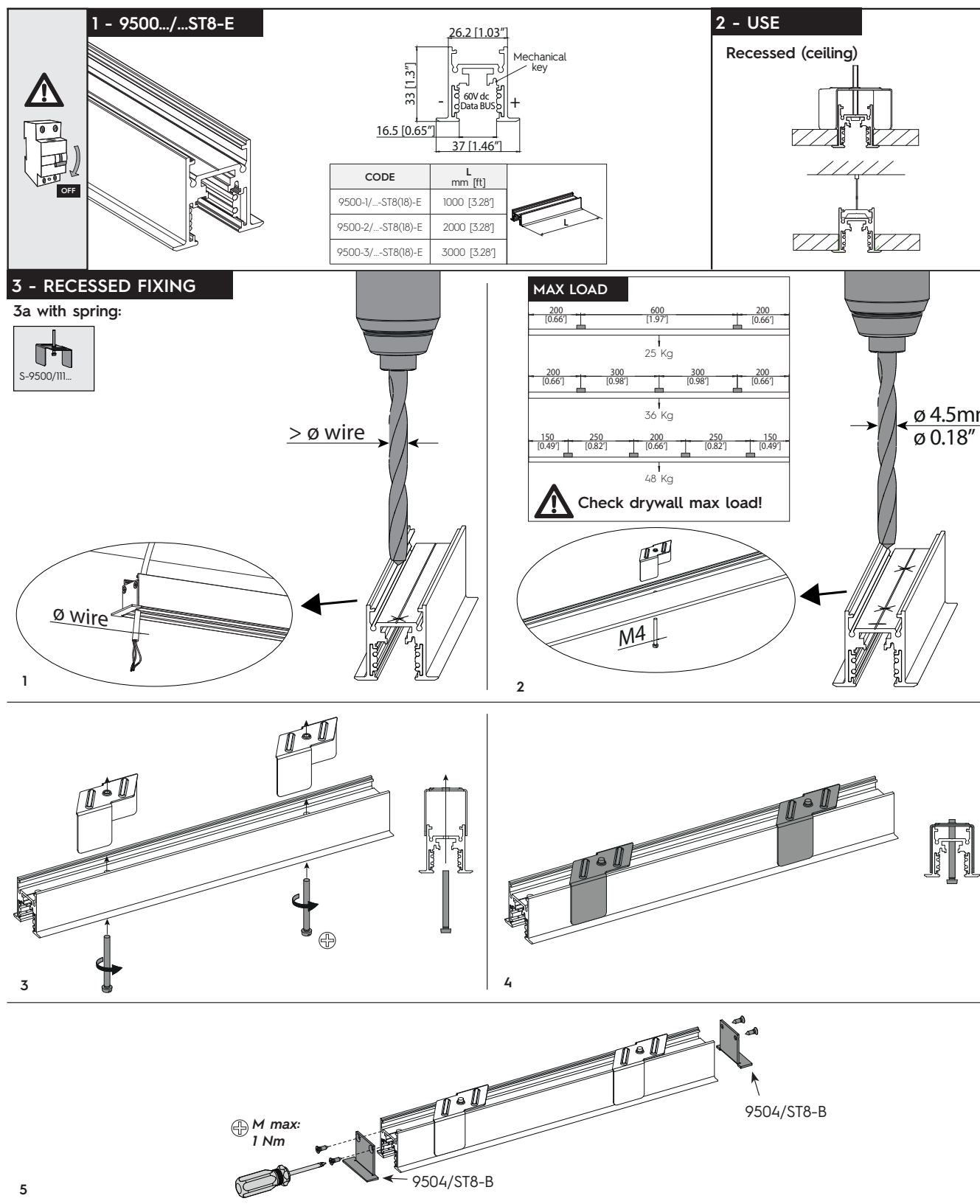

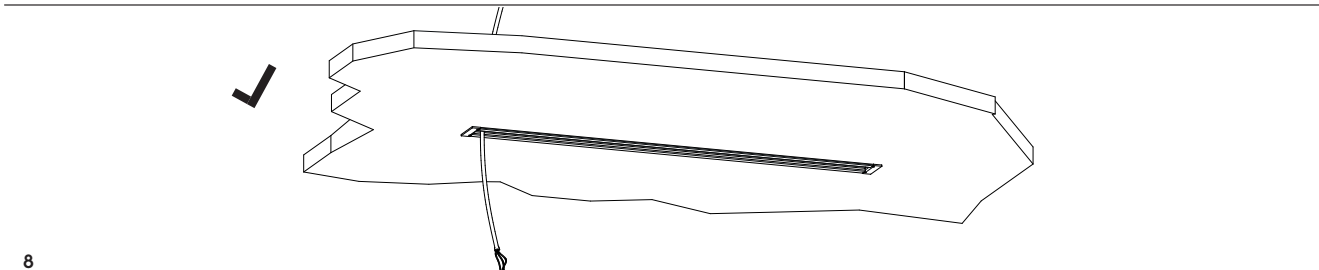
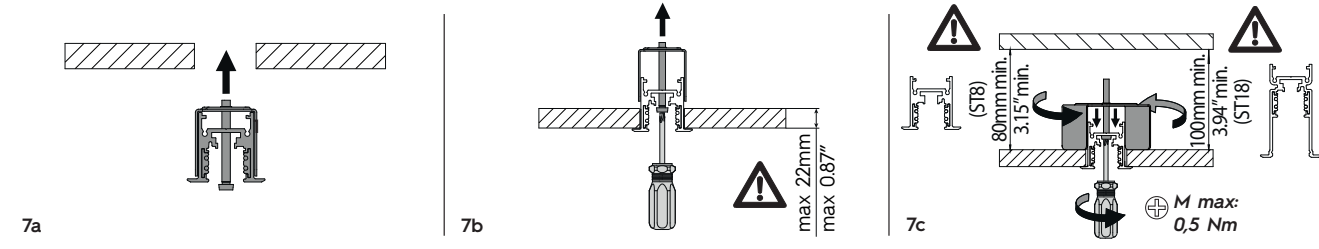
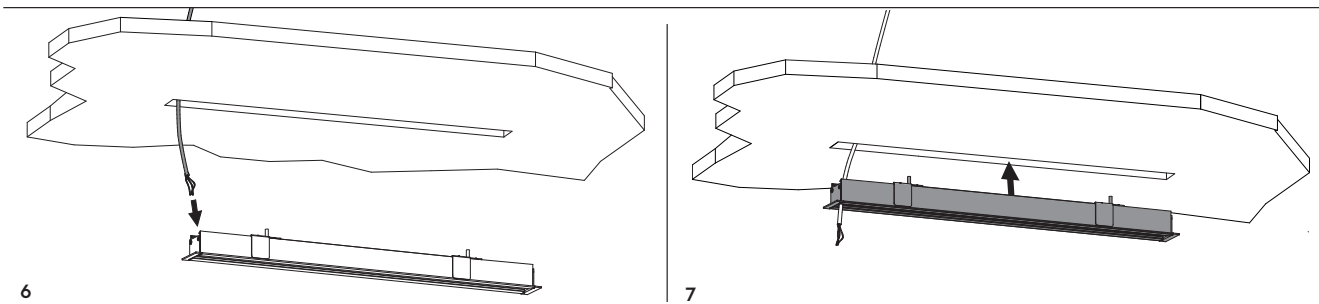

### 3b with rigid suspension sets

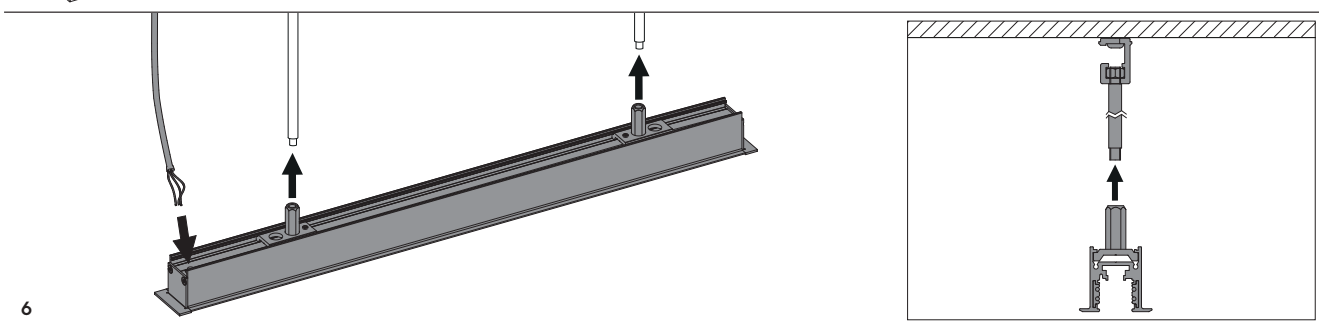
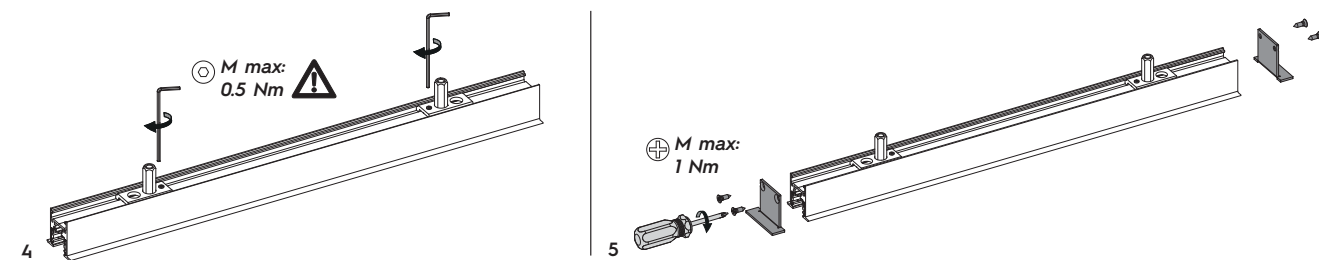
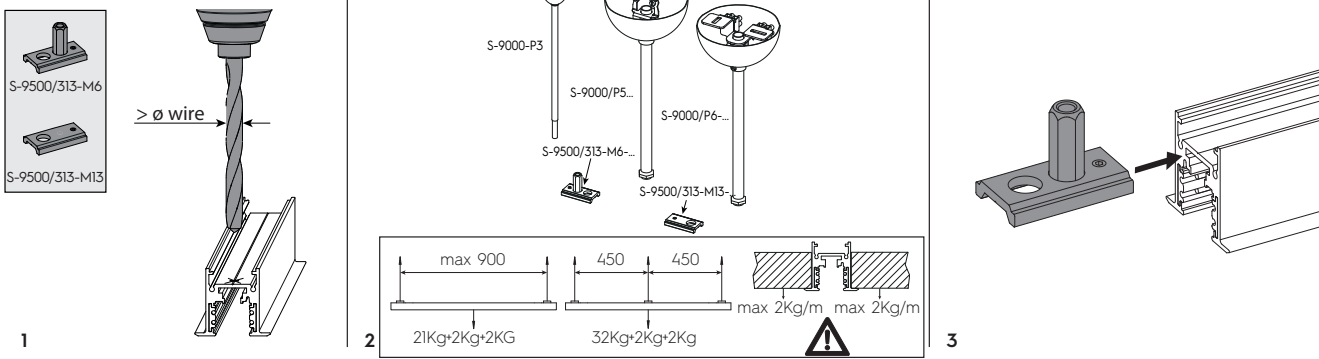

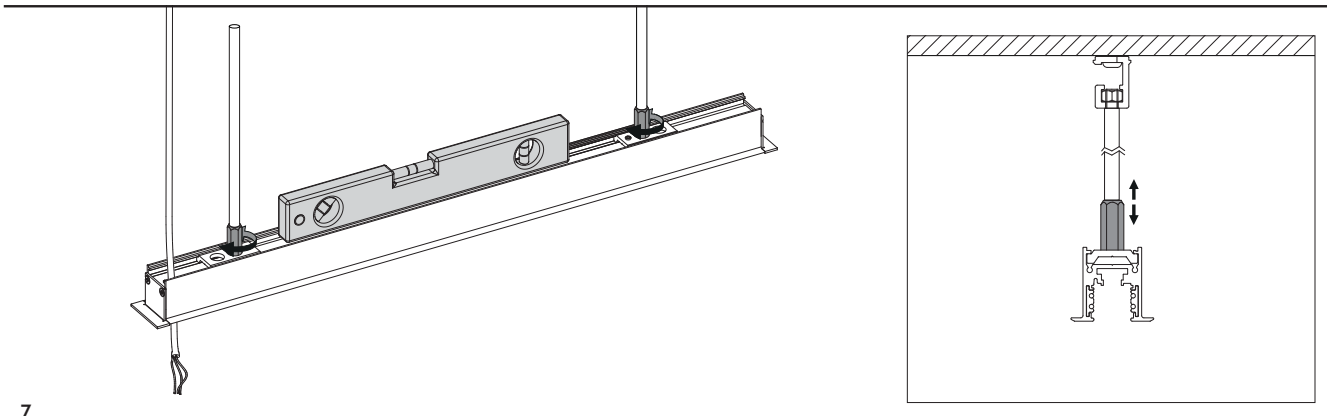

7

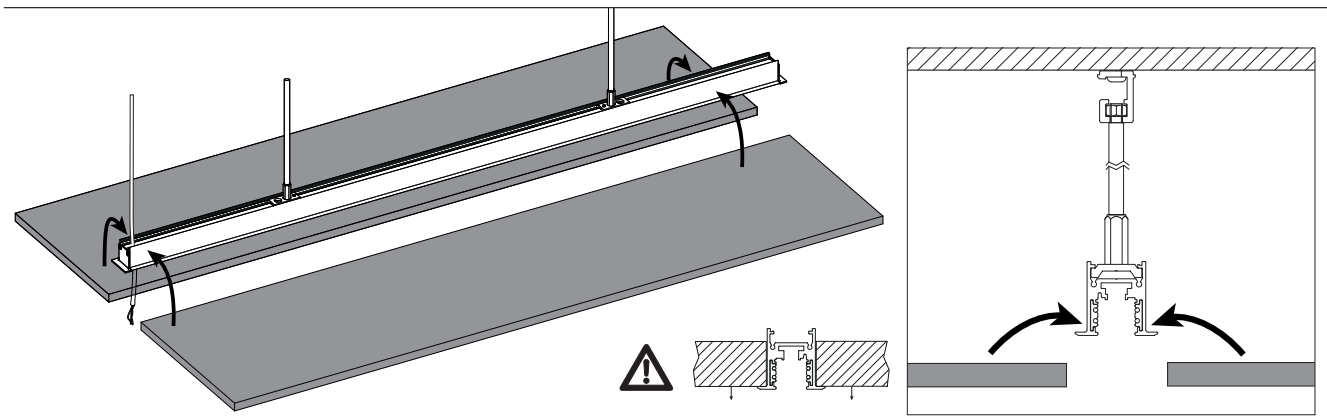

8

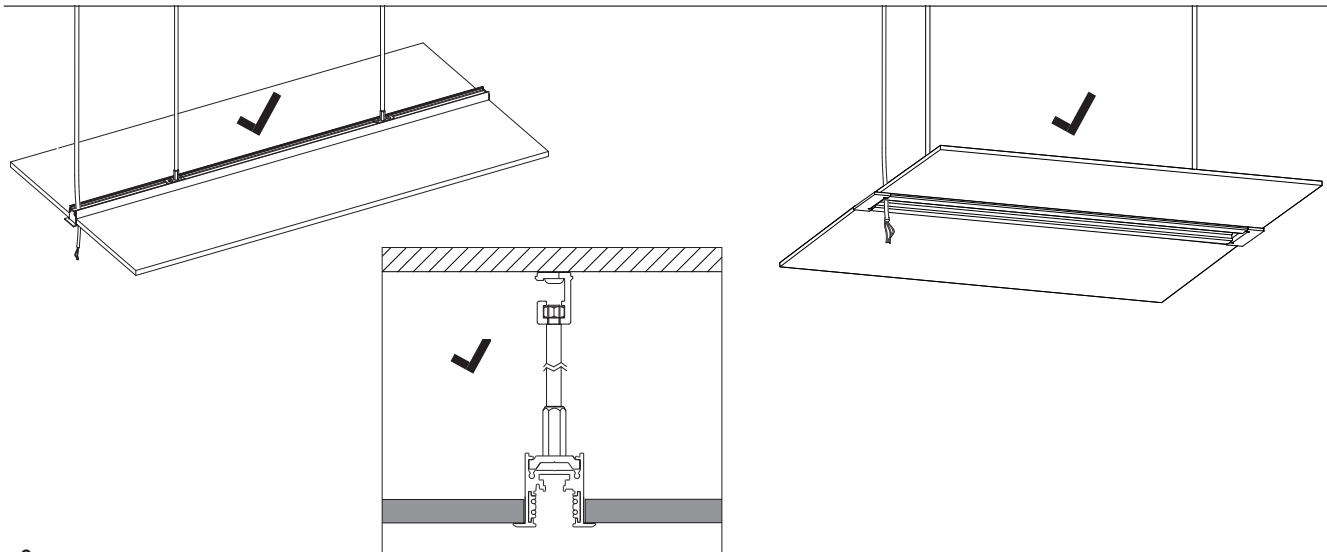

9

### 3c with brackets/clamps

**a**

S-9500/313-LA  
S-9000/218-...+602/F  
S-9500/313-SV

**b**

S-9500/114-T  
S-9500/115

9500-KIT1-...

S-9000/216

S-9000/211-S-...

S-9500/114-T

S-9500/313-LA  
S-9000/218+602/F

S-9000/132

S-9000/214

S-9000/215

S-9000/3

S-9000/211-S-...

S-9500/115...

S-9500/313-SV-...

max 900

20Kg+2Kg+2kg

450 450

32Kg+2Kg+2kg

max 2Kg/m max 2Kg/m

1

2

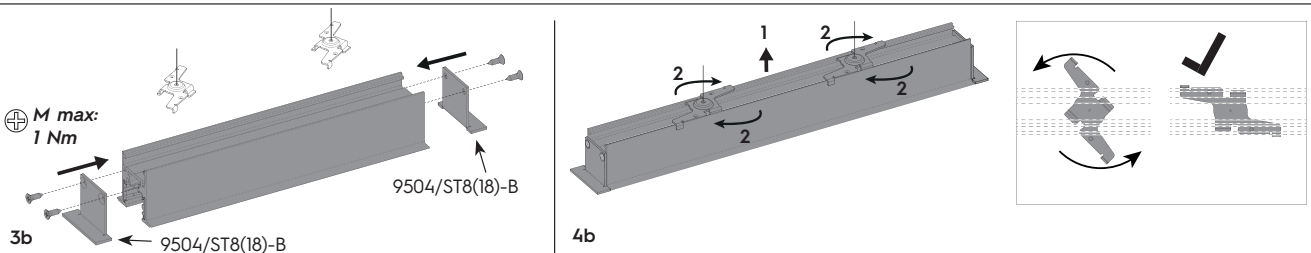
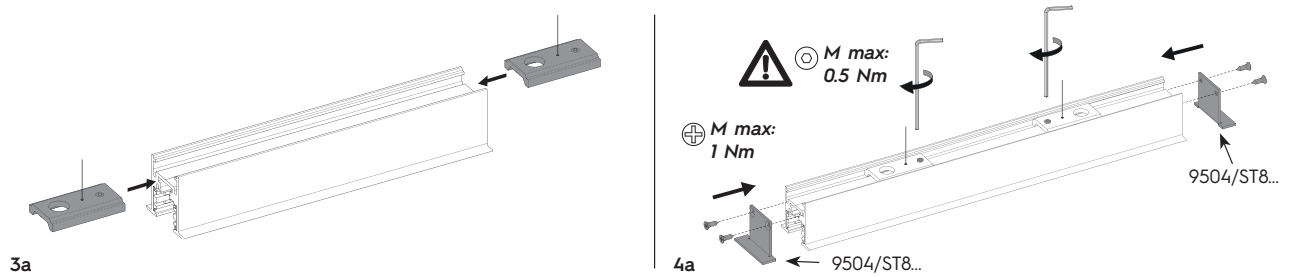

#### 4 - IN ROW USE

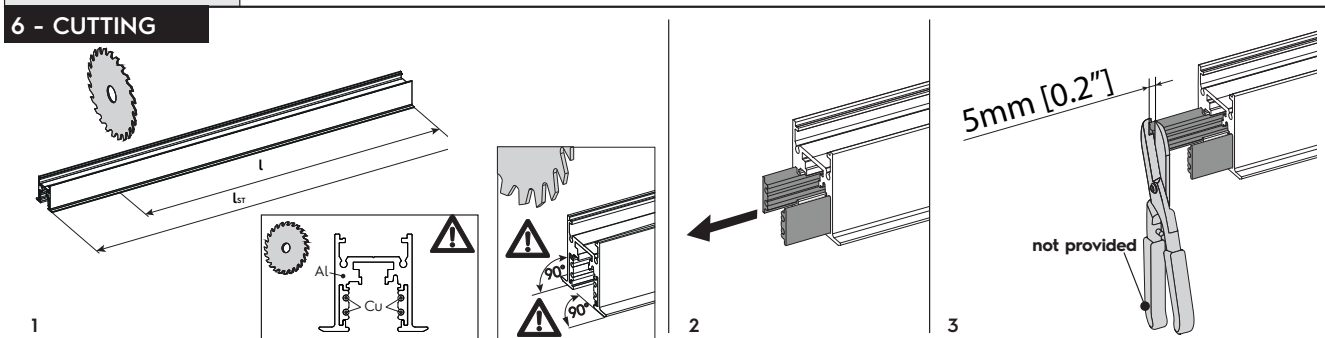
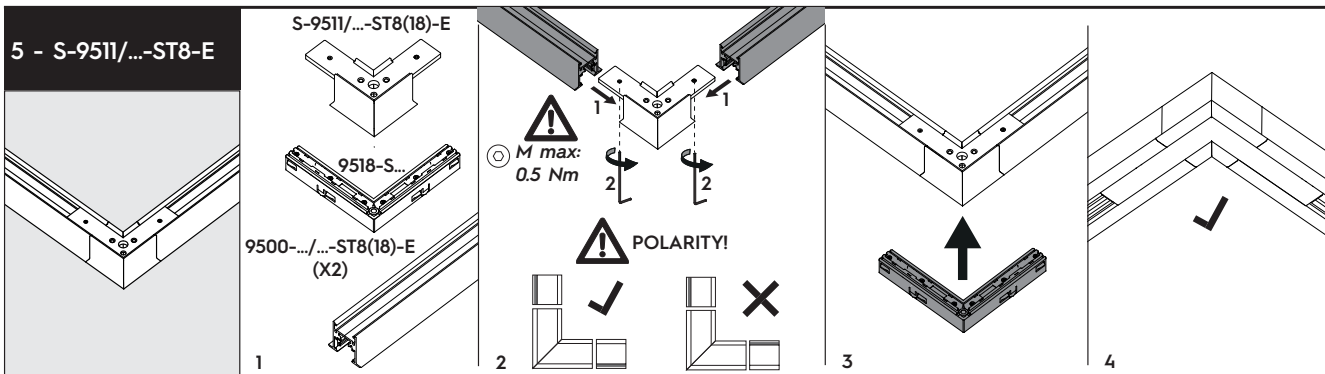
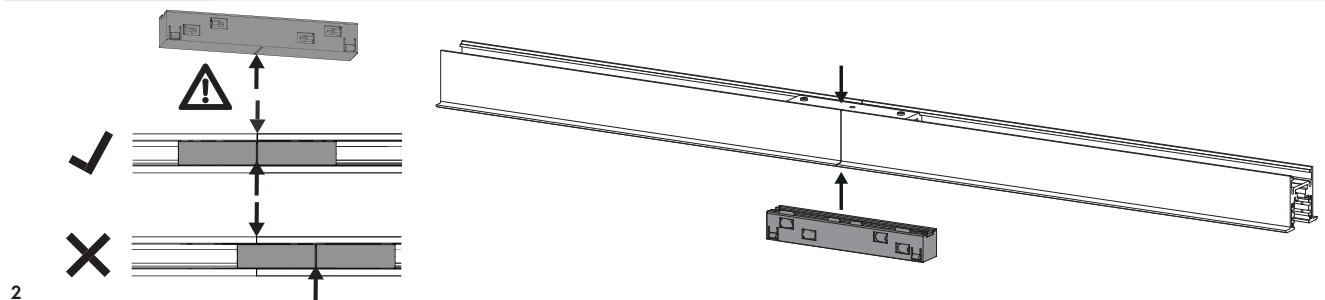
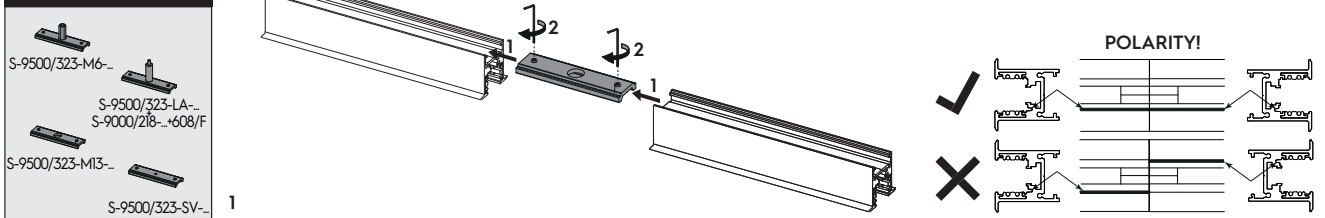



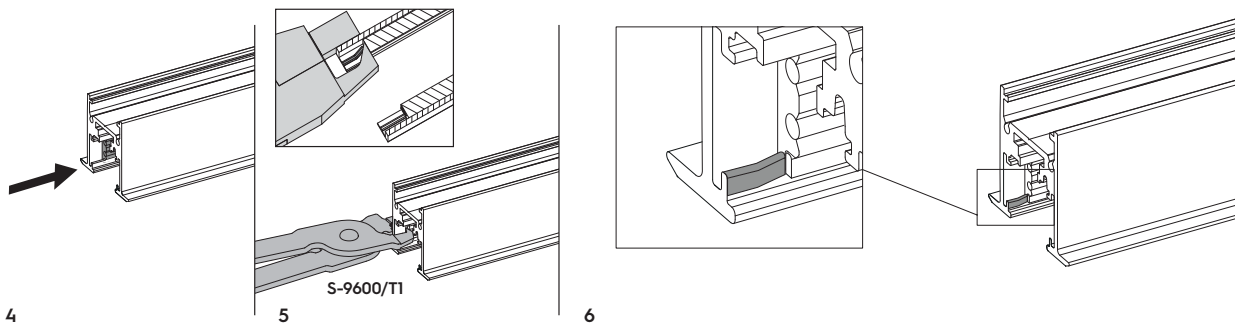

## 7 - 9501-S/...-E

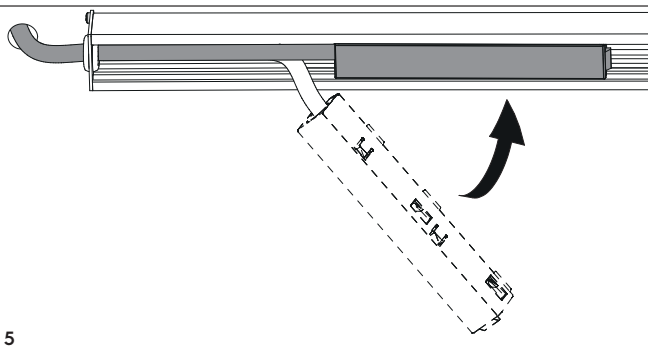
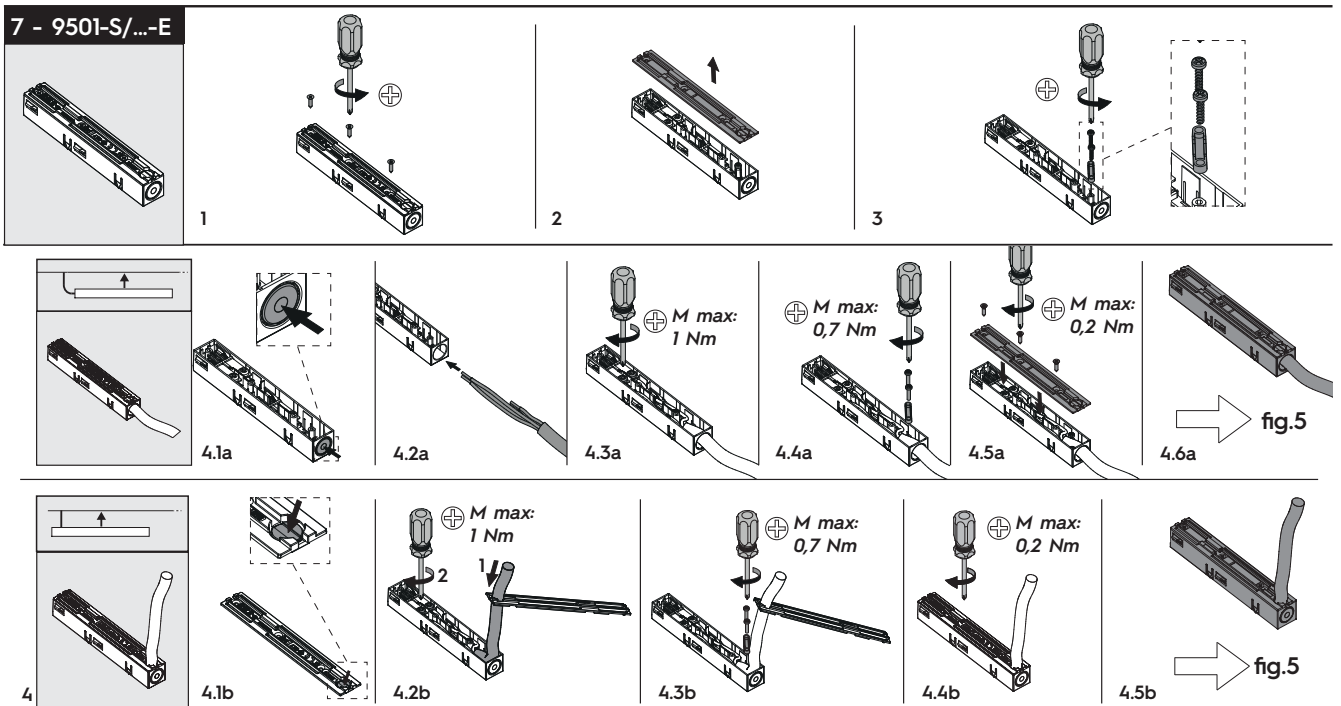

## 8 - 90° ANGLE

